

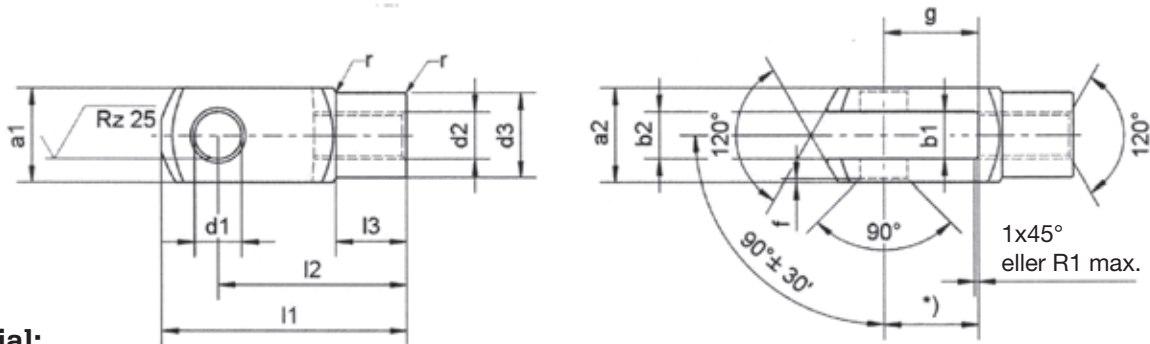

Gaffelhuvud

DIN 71752



Material:

Förzinkat stål.

Size	d1 H9	g ± 0.5	a1 h 11	a2 + 0.30	b1 B 13	b2 tol.	d2 standard	d2 fingänga	d3 ±0.3	f ±0.2	l1 ±0.5	l2 tol.	i3 ±0.2	r ³⁾	Vikt per st (kg)
G 4x8	4	8	8		4	B13	M 4x0.7		8	0.5	21	16	6	0.5	0.005
G 4x16	4	16	8		4		M 4x0.7		8	0.5	29	24	6	0.5	0.007
G 5x10	5	10	10		5		M 5x0.8		9	0.5	26	20	7.5	0.5	0.009
G 5x20	5	20	10		5		M 5x0.8		9	0.5	36	30	7.5	0.5	0.013
G 6x12	6	12	12		6		M 6x1		10	0.5	31	24	9	0.5	0.015
G 6x24	6	24	12		6		M 6x1		10	0.5	43	36	9	0.5	0.021
G 8x16	8	16	16		8		M 8x1.25		14	0.5	42	32	12	0.5	0.037
G 8x16FG	8	16	16		8			M 8x1	14	0.5	42	32	12	0.5	0.037
G 8x32	8	32	16		8		M 8x1.25		14	0.5	58	48	12	0.5	0.054
G 8x32FG	8	32	16		8			M 8x1	14	0.5	58	48	12	0.5	0.054
G 10x20	10	20	20		10		M 10x1.5		18	0.5	52	40	15	0.5	0.074
G 10x20FG	10	20	20		10			M 10x1.25	18	0.5	52	40	15	0.5	0.074
G 10x40	10	40	20		10		M 10x1.5		18	0.5	72	60	15	0.5	0.116
G 10x40FG	10	40	20		10			M 10x1.25	18	0.5	72	60	15	0.5	0.116
G 12x24	12	24	24		12	M 12x1.75		20	0.5	62	48	18	0.5	0.121	
G 12x24FG	12	24	24		12		M 12x1.25	20	0.5	62	47	18	0.5	0.121	
G 12x48	12	48	24		12	M 12x1.75		20	0.5	86	72	18	0.5	0.175	
G 12x48FG	12	48	24		12		M 12x1.75	20	0.5	86	72	18	0.5	0.175	
G 14x28	14	28	27		14	+0.7 +0.15	M 14x2		24	1	72	56	22.5	1	0.178
G 14x28FG	14	28	27		14		M 14x1.5		24	1	72	56	22.5	1	0.178
G 14x56	14	56	27		14	M 14x2		24	1	101	85	22.5	1	0.258	
G 14x56FG	14	56	27		14		M 14x1.5	24	1	101	85	22.5	1	0.258	
G 16x32	16	32	32		16	M 16x2		26	1	83	64	24	1	0.282	
G 16x32FG	16	32	32		16		M 16x1.5	26	1	83	64	24	1	0.282	
G 16x64	16	64	32		16	M 16x2		26	1	115	96	24	1	0.411	
G 16x64FG	16	64	32		16		M 16x1.5	26	1	115	96	24	1	0.411	
G 18x36	18	36	36		18	M 18x2.5		30	1	94	72	27	1.5	0.390	
G 18x36FG	18	36	36		18		M 18x1.5	30	1	94	72	27	1.5	0.390	
G 20x40	20	40	40		20	M 20x2.5		34	1	105	80	30	1.5	0.550	
G 20x40FG*	20	40	40		20		M 20x1.5	34	1	105	80	30	1.5	0.550	
G 20x80	20	80	40		20	M 20x2.5		34	1	145	120	30	1.5	0.800	
G 20x80FG	20	80	40		20		M 20x1.5	34	1	145	120	30	1.5	0.800	
G 25x50	25	50	50		25	M 24x3		42	1.5	132	100	36	1.5	1.100	
G 25x50FG*	25	50	50		25		M 24x1	42	1.5	132	100	36	1.5	1.100	
G 28x56	28	56	55		28	M 27x3		48	1.5	148	112	40	2	1.500	
G 28x56FG	28	56	55		28		M 27x2	48	1.5	148	112	40	2	1.500	
G 30x54FG*	30	54	55		30	+0.7 +0.15	M 27x2		48	1.5	148	110	40	2	1.440
G 30x60	30	60	60		30		M 30x3.5		52	1.5	160	120	42	2	1.970
G 30x60FG	30	60	60		30		M 30x2	52	1.5	160	120	42	2	1.970	
G 35x54FG*	35	54	70		35		M 36x2	60	2	188	144	54	3	2.930	
G 35x72	35	72	70		35	M 36x4		60	2	188	144	54	3	2.930	
G 35x72FG	35	72	70		35		M36x2	60	2	188	144	54	3	2.930	
G 36x72	35	72	70		36	M 36x4		60	2	188	144	54	3	2.930	
G 36x72FG	35	72	70		36		M 36x2	60	2	188	144	54	3	2.930	
G 40x84FG*	40	84	85		40		M 42x2	70	3	232	168	63.5	5	5.640	
G 42x84	42	84	85		42	M 42x4.5		70	3	232	168	63.5	5	5.340	
G 42x84FG	42	84	85		42		M 42x2	70	3	232	168	63.5	5	5.340	
G 50x96	50	96	96		50	M 48x5		82	3	265	192	73	5	7.860	
G 50x96FG*	50	96	96		50		M 48x2	82	3	265	192	73	5	7.860	

FG= Fingängad